

# Journal of Social and Political Sciences

**Dwijendra, Ngakan Ketut Acwin. (2019), Morphology of House Pattern in Tenganan Dauh Tukad Village, Karangasem Bali, Indonesia. In: *Journal of Social and Political Sciences*, Vol.2, No.1, 184-192.**

ISSN 2615-3718

DOI: 10.31014/aior.1991.02.01.60

The online version of this article can be found at:  
**<https://www.asianinstituteofresearch.org/>**

Published by:  
The Asian Institute of Research

The *Journal of Social and Political Sciences* is an Open Access publication. It may be read, copied and distributed free of charge according to the conditions of the Creative Commons Attribution 4.0 International license.

The Asian Institute of Research *Social and Political Sciences* is a peer-reviewed International Journal. The journal covers scholarly articles in the fields of Social and Political Sciences, which includes, but not limited to, Anthropology, Government Studies, Political Sciences, Sociology, International Relations, Public Administration, History, Philosophy, Arts, Education, Linguistics, and Cultural Studies. As the journal is Open Access, it ensures high visibility and the increase of citations for all research articles published. The *Journal of Social and Political Sciences* aims to facilitate scholarly work on recent theoretical and practical aspects of Social and Political Sciences.



ASIAN INSTITUTE OF RESEARCH  
Connecting Scholars Worldwide



# Morphology of House Pattern in Tenganan Dauh Tukad Village, Karangasem Bali, Indonesia

Ngakan Ketut Acwin Dwijendra<sup>1</sup>

<sup>1</sup> Department of Architecture, University of Udayana, Bali, Indonesia

Corresponding Author: Ngakan Ketut Acwin Dwijendra. Department of Architecture, University of Udayana, Bali, Indonesia. Telp: +62 81233009333, E-mail: acwin@unud.ac.id

## Abstract

Traditional Settlements Tenganan Dauh Tukad Traditional Village, Karangasem regency, has a uniqueness of traditional dwelling patterns that become the local character of the region. However, along with the development of tourism in this village, the traditional settlement is not only a pride but also the object of commodification. This is an interesting phenomenon where on the one hand, people try to maintain their traditional residential identity to attract tourists visiting, but, on the other hand, they change their dwelling as a tourism facility. The change is a challenge and pressure for maintaining the traditional configuration as an identity. This is a phenomenon of conflict in the development of a cultural tourism area. On the one hand, tourists expect natural and original nature and culture. On the other hand, society and culture change as the society interacts with the outside culture and the desire to accommodate the needs of the visiting tourists. Therefore, the purpose of this study was to investigate the paradoxical phenomenon of changes in the morphology of residential patterns in Tenganan Dauh Tukad Village and explore the conflict between conservation of traditional housing character and tourism demand. By conducting field studies (measurements), of selected, stratified random sampling houses, and interviews, to examine the impact of changes on values and their meanings, this study will discuss changes in the physical configuration, meanings, and values of a traditional house. This research will explore the original roles and meanings of altered housing that can still be maintained and the new roles and values contained in the new configuration. In this study will also discuss the impact of new values on the meaning and value of the original configuration. With the identification of the morphologic character of the residential pattern, it is expected to be a model of change and provide an appropriate perspective for the community, the government and the tourism actors in transforming the traditional housing in Tenganan Dauh Tukad Village, Karangasem Regency.

**Keywords:** Morphology, Housing Pattern, Traditional, Local Identity, Tourism

## INTRODUCTION

### *Background*

The traditional settlement of Tenganan Dauh Tukad Traditional Village, Karangasem Regency, has a unique spatial configuration of traditional residential patterns that become the local identity of the region. However,

along with the development of tourism in this village, the traditional settlement is not only a pride but also the object of commodification. Increased tourist visits encourage the development of tourism facilities that resulted in changes in the configuration of traditional village space Tenganan Dauh Tukad Village. This is an interesting phenomenon where on the one hand, people are proud and try to maintain their traditional residential areas and patterns to attract tourists visiting, but, on the other hand, they change their occupancy patterns as tourism facilities. The focus of this phenomenon is that changes in occupancy patterns indicate a great challenge in the era of economic tourism in maintaining the authenticity of the spatial configuration of housing as an expression of cultural identity.

The pattern of settlements Tenganan Dauh Tukad Village closely related to the cultural philosophy, namely the cultural philosophy of Bali is the concept of *Rwa Bhineda*, *Tri Hita Karana*, and *Tri Mandala*, which is manifested into the concept of spatial, cultural preservation area Tenganan Dauh Tukad Village. But tradition is not static where a tradition undergoes a gradual process of change (Eisenstadt 1973; Gusfield 1967; Williams 1983; Clifford 1994). A tradition does not simply repeat the previous tradition but is a selective process of adopting new things. A new tradition will undergo a screening process, adjustments, and modifications tailored to the existing needs (Geriya 2007; Mantra 1993; Nordholt 1986; Vickers 1989; Agung 1991; Dharmayuda 1995; Picard 1996). The interaction of people with outside cultures influences the process of receiving new traditions in a society (Gusfield 1967). The focus of this discussion is the discussion of the dynamic cultural change in anticipating the impact of tourism. The change is a challenge and pressure for maintaining the traditional configuration as an identity. As a researcher in the field of architecture, social, culture, and tourism building, the research team was able to describe the existing problems and identify and assess the phenomenon of morphological changes in traditional shelter patterns as a response to maintain local identity and meet tourism challenges.

### **Research Question**

From the above background can be raised the problems faced by Tenganan Dauh Tukad Village, Karangasem are as follows:

1. What is the development of the morphology of residential patterns from the Tenganan Dauh Tukad Village?
2. How does the configuration change affect the values and meanings of the original configuration of the occupancy pattern as well as the factors behind the change?

### **Research Objectives**

This change is a challenge for public and government efforts to maintain the natural conditions, culture, and traditions of the people who are the tourism development resources. On the other hand, society and culture change as the society interacts with the outside culture and the desire to accommodate the needs of the visiting tourists.

Therefore, the purpose of this study are:

- 1 Investigating the paradoxical phenomenon of changing the development of residential patterns in this village, what is the true pattern of the original dwelling? The extent to which changes in the morphology of the occupancy pattern and their development and what are the factors causing the morphology, to explore the new roles and values contained in the new configuration and also discuss the impact of new values on the meaning and value of the original configuration. So this research explores the conflict between the importance of conservation of traditional housing character and the demands of tourism.
- 2 This study is dedicated to providing guidance on how to make housing change as a response to meet the needs of tourism and conservation interests of traditional residential areas.

### **Outcome Targets and Research Benefits**

The emphasis of the study to be examined is on the transformation of occupancy-based traditional morphology types that are occupied with the changes in demography, lifestyle changes and the development of tourism. The transformation of the typology of residential morphology is a process of change (as a distinguishing element), as

well as existence (as a fixed element) occurring at home, in accordance with applicable architectural principles. The targets and outcomes of residential transformation research of Tenganan Dauh Tukad Traditional Village, Karangasem Regency are:

1. The original morphological type of housing.
2. Changes in occupant characteristics associated with morphological type transformation.

Furthermore, this research is expected to provide great benefits and contribution for both government and society such as:

1. To contribute beneficial to the community and implement the policy of tourism development which is one of the national development priority programs.
2. To contribute theory about the transformation of traditional housing in Tenganan Dauh Tukad Village, Karangasem.
3. To be used as a foundation to determine the direction of development of conservation program of a traditional residential building of world cultural heritage area of Tenganan Dauh Tukad Village, especially in Bali, and Indonesia in general.

### ***Literature Review***

Tradition is classically defined in the 1950s and 1960s as static, with little innovation based on the elite tradition of tradition in a society. Nevertheless, today, tradition is not always a static phenomenon but a gradual transformation process (Eisenstadt 1973). The idea of a tradition is very accommodating that can be transformed into an intergenerational transmission process. This transmission process refers to ideas from human responses to old traditions with little or no change (Shils 1971, 1981).

There are several kinds of things that affect the transformation as Soekanto (1984:10) noted that is:

1. Technology caused by all aspects of life involves technology.
2. Lifestyle and demography, with the influence of time and changes in job classification, age, and status level influences.
3. Politics is closely related to the policy of the holder of power.
4. The economic view of the conditions and developments in the field of community business.

Using the theories of transmission of the tradition above, the notion of transformation is a housing production and the architecture and traditions within it are being explored to understand the ways in which communities construct their homes and housing as a physical form of culture, as a response to new conditions and to show their identity.

## **RESEARCH METHODS**

The type of research conducted is explorative descriptive that is research that is digging and telling or describing a phenomenon in a non-experimental way, consisting of the following stages:

### ***Data Collection Stages***

- a. Research design
  - Choose a problem and formulate the problem
  - Determine the variables and data sources: settlement patterns and housing and morphological type of house (shrine, pavilion, natah)
  - Conducting a literature study on the patterns and types of traditional housing in Bali and that developed in the village.
- b. Implementation of Research Data Collection
  - Determining and organizing instruments
  - Selection of research objects with criteria: traditional houses that have not changed the configuration of the space and traditional homes that have undergone changes in space configuration

- Collecting building data in accordance with the above criteria with a tiered information system from informants previously interviewed and so next, so that obtained some objects in accordance with the above criteria.
- Collect data by conducting interviews to homeowners and related institutions related to the status of the temple and the year of development and restoration ever done.
- Measuring traditional houses using theodolite or meter is aided by a checklist and check list
- Data tabulation

### Stage Analysis and Results

- Data processing: perform data editing, data encoding, and data presentation
- Implementation of data analysis: tabulation of each variable that has taken data from each building object, describes morphology type of existing traditional house, spatial changes that occur in housing, as well as the impact of transformation on changes in value and meaning.
- Conclusion research and recommendations: formulate conclusions and suggestions.

## RESULT AND DISCUSSION

### Results

Basically, the yard pattern applied in Balinese society is based on the concept of *Sanga Mandala*. In Tenganan Dauh Tukad Village Karangasem, the concept of *Sanga Mandala* is not so a guide in the formation of yard pattern. The formation of yard pattern is based on the concept of *Tri Hita Karana*. Through the concept of *Tri Hita Karana*, the yard formed elongated perpendicular to the main road. The division of space according to the concept of *Tri Hita Karana*, that *parahyangan* area is near the mountain and the road, and further away from both the orientation of the mountain and the way the value of space decreases, i.e., *pawongan* and *palemahan* (Figure 1 and Figure 2).

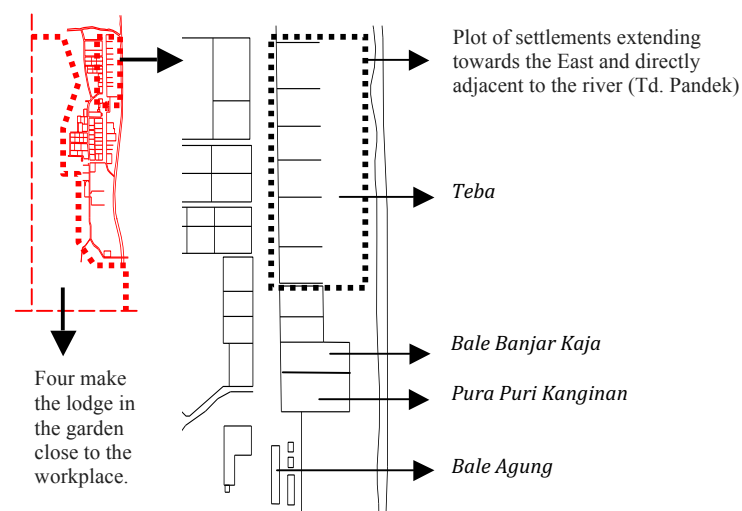

Figure 1. Patterns of Expanding Eastward Settlements in Tenganan Dauh Tukad Village, Karangasem Bali

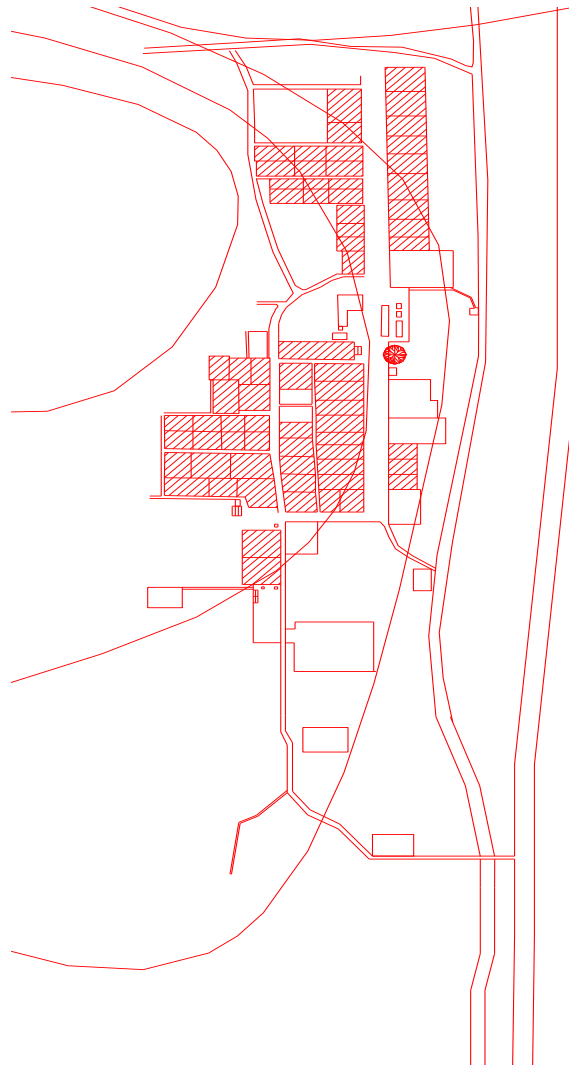

Figure 2. Morphological Pattern of Tenganan Dauh Tukad Village, Karangasem Bali

The uniqueness of yard pattern in Tenganan Dauh Tukad Village, Karangasem as shown in Figure 3 are:

1. Residential pattern in Tenganan Dauh Tukad settlement has characteristic of traditional settlement of plot of *natah* pattern with *sanga mandala* concept which is formed from *sanggah*, *bale dangin*, *bale daja/meten*, *middle bale*, *bale dauh*, and *pawon*.
2. *Sanggah* is a place of family worship mainly to the ancestors and God *Ida Sang Hyang Widhi*.
3. *Bale Dangin*, is a place to hold a religious ceremony, as a bed of grandparents and can also be used to store ceremonial means/equipment. *Bale dangin* is typically six with a long rectangular plan, one or two sides (*kangin* and *kelod*) covered by a wall while the other side is open.
4. *Bale Daja /Meten*, serves as a place to sleep and store valuables/heirlooms. The shape of the rectangular metallic *bale* plan consists of eight columns, and there are also 12 poles. The four sides are covered with walls.
5. *Pawon*: because the mountain area is cold enough, the *pawon* that serves as a place to cook and work for women contains *bale* (bed) and preparations to make materials offerings / *banten*. *Pawon* is usually six-masted and surrounded by walls on all four sides.
6. *Bale Dauh*, serves as a workplace during the day, and bed at night. *Bale dauh* had a six-poster and was surrounded by a wall. Side facing the open (no walled) tab.

7. *Bale Tengah*, is a place to hold a religious ceremony. Bale is a six-capped with a closed on one side of the north side.
8. *Angkul-angkul* serves as the entrance. The settlements in the core area of the village have two types of *angkul-angkul* namely *angkul-angkul* as the entrance of the main shaft and *angkul-angkul* as the entrance from the shell to the yard of the house. While in the development area only has one *angkul-angkul*.

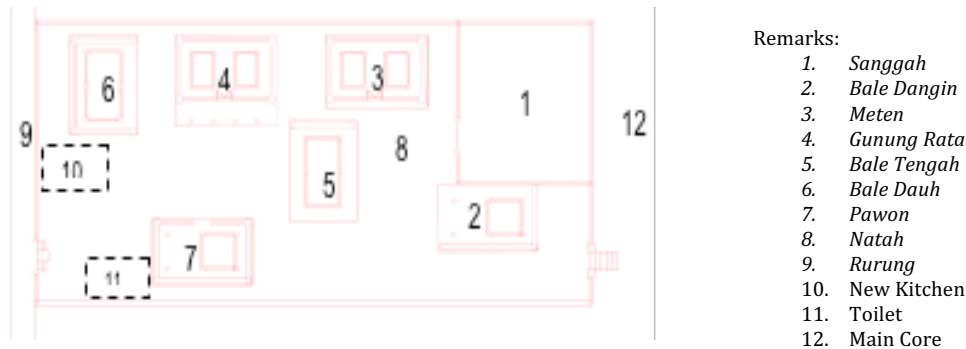

Figure 3. House Pattern in Tenganan Dauh Tukad Village, Karangasem Bali

## Discussion

### Morphological Changes in House Patterns

The transformation of the traditional house in Tenganan Dauh Tukad Village, Karangasem was identified by comparing the object of research with traditional house which still shows its original shape. Categorization is done to indicate the rate of change of transformed residential units. Below is Table 1 which shows the relationship of categories of residential units with the intensity of transformation in Tenganan Dauh Tukad Village, Karangasem are:

- a. Category A: Intensity of Transformation of Small House Units. It can be reviewed based on aspects of material change and shape, functional changes, and the absence of new space in one plot.
- b. Category B: Intensity of Transformation of House Unit Simply, including the existence of material and shape changes, while the function of fixed space, and no new space in one lot.
- c. Category C: Intensity of Transformation of Multiple House Units. These include material and shape transformations, space/fixed function transformations, and there is a new space in one lot.
- d. Category D: The Intensity of Transformation of Huge House Units. Transformation involves the transformation of material and form, function transformation, existence of new space with a new function.

Based on the categorization of the transformation of the above house units, the transformation of house units is categorized into 4 types (Table 1) such as:

#### 1. Category A - Original House - Little Change - 7 Houses

Category A occupancy is the least transformed occupancy, and even this dwelling has not undergone a transformation at all.

The pattern of fixed space, the form of the house (proportion and size) is fixed, and still use the original material that is the roof of the reeds, the roof structure and wooden pole, the walls of compacted soil, the floor in the form of compacted soil or hardened with a flat stone.

Table 1. Categorization Of House Transformation

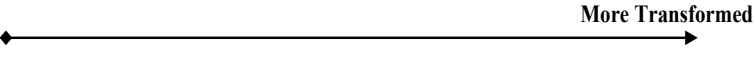
Morphology Type	<div style="text-align: right; margin-bottom: 0;">  </div>			
	Category A	Category B	Category C	Category D
Material	Constant	Change	Change	Change
Form	Constant	Change	Change	Change
Function	Constant	Constant	Change/Constant	Change & New
Spatial Pattern	Constant	Constant	Change	Change & New

Source : Manik (2007).

## 2. Category B - Enough Changes - 22 Houses

Category B occupancy undergoes a transformation of material and form, while function and layout tend to remain the same as the original state. Changes are mainly the use of materials for floors, walls, and roofs. Changes lead to the use of more practical materials, saving on costs, time and effort. Changes also occur with the addition of new buildings that occupy vacant land around the house so as not to change the existing mass patterns and forms of natah that is traditionally very useful at the time of religious ceremonies, Fixed spatial pattern, fixed house shape while the material used in accordance with the development of zinc roof, asbestos or tile; masonry or brick walls, the floor is plastered.

## 3. Category C - Many Changes - 31 Houses

The visually visible transformation of Category C occupancy is in the material, building form, spatial function, and spatial pattern. The average occupancy category C adds new buildings as well as changing the shape of new buildings by adding new functions to the building. The shape of a new building that is influenced by the forms of modern buildings that are usually called office bale.

The pattern of fixed space, the shape of the house changed most of the changes occurred in bale daja and bale delod which is used as a sleeping room. In addition, there are also additional new functions such as bathrooms, additional kitchens, and stalls. But sanggah, bale dangin that is used for ceremony and pawon usually remain. The use of the material also changes the roof of zinc, asbestos or tile; masonry or brick walls, floor plastered or with ceramic finishing.

## 4. Category D- Very Many Changes - 13 Houses

Transformation of Category D occupancy includes the development of both the basic pattern of residential units, the shape and use of materials. But the fixed element in this type of D house is bale gede building because its function is very complex. Bale gede berfungsi sebagai place to receive guests, place of execution ceremony manusa yadnya and pitra yadnya especially at the time of death, bale gede has a big role as place pelaksanaan yadnya.

The pattern of space, the shape of the house, and the material changes and more to the modern building which consists of a period that accommodates all the functions that exist. But what remains is sanggah and bale dangin.

## **Factors Cause Occurrence Morphological Change Occupational Patterns**

The construction of infrastructure to facilitate the flow of transport of agricultural products and plantations outside the village affects the need for adequate means of transportation. Ownership of motor vehicles will certainly demand a space that is a garage, both temporary and permanent. In addition, tourism activities around the area led to the start of facilities and infrastructure supporting tourism such as shops and shops that affect the transformation of traditional homes.

The development of activities requires the transformation of residential units functions. The enclosed space traditionally only functioned as a bed, is now also used as a dining room and family room. The joint activity that



was initially carried out on the terrace and the yard have now entered into an enclosed space. This shows the occupants increasingly need private space as a means to express themselves respectively. Built-in office *bale* is one example. *Bale* office that has a family room and additional sleeping space indicates there has been a transformation function of residential units. The reason for the fulfillment of space needs is closely related to the increasingly complex activity patterns along with the development of the era. Transformation of activity patterns refers to the increasingly complex lifestyle of the inhabitants.

Some changes to the transformation and its causal factors can be described as follows:

1. Material Changes - Technological Factors, Economics, Lifestyle/Socio-Culture. Along with the development of the era, building technology found more sophisticated so mass produced, the use of traditional materials (wood, alang-alang and land popolan) began to be reduced even no longer exists.
2. Shape Changes - Technological Factors, Economics, Lifestyle/Social Culture. The shape of the shelter is more affected by the transformation of building materials, such as the change of the roof slope due to the use of tile and zinc, the use of stone material makes possible the manufacture of carved stone and the use of ceramics for the floor display bright colors.
3. Spatial and Spatial Changes - Demographic, Economic, Lifestyle/Socio-Cultural Factors. The enclosed space traditionally only functioned as a bed, is now also used as a dining room and family room. The joint activity that was initially carried out on the terrace and the yard have now entered into an enclosed space.

## CONCLUSION

Based on the above results and discussion can be summarized as follows:

1. There has been a transformation of residential units in Tenganan Dauh Tukad Village, Karangasem where changes from only a few (Category A) to very large changes (Category D), from material changes (Category B) to spatial changes (Category D).
2. Factors that cause transformation is due to technological progress factors, demography, lifestyle, socio-cultural and economic.

Some suggestions that can be formulated are as follows:

1. Conservation needs to be done to maintain the existing potential, as well as to be able to support the development according to the potential possessed by this region. The proper form of preservation in Tenganan Dauh Tukad Village, Karangasem is in the form of conservation, preservation, and revitalization. Conservation is applied to the visual aspect of components such as protection forests and temples, paddy fields and terraces. Preservation is applied to aspects of the temple, village pattern, *bale banjar*, *bale desa*; Functional aspects such as land use and circulation: visual aspects such as: structure and pattern of *natah*.
2. Need to be done arrangement of residential areas and units so that the transformation does not change the meaning and values contained in the spatial area. This needs to be formulated model design or home prototype as guide/reference/model for residents in transforming their home in Tenganan Dauh Tukad Traditional Village, Karangasem.

## ACKNOWLEDGMENTS

Acknowledgments to those who have supported the writing of this paper are LPPM and the Faculty of Engineering Udayana University for the support of research grants and Village Head and all communities and respondents Tenganan Dauh Tukad Traditional Village, Karangasem.

## REFERENCES

- Brubaker, R & Cooper, F (2000) 'Beyond identity,' *Theory and Society*, vol. 29, no. 1, pp. 1-47.
- Clifford, J (1994) *The predicament of culture: twentieth-century ethnography, literature, and art*, Harvard University Press, Cambridge.
- Covarrubias, M (1974) *Island of Bali*. Kuala Lumpur: Oxford University Press.

- Derek & Japha, V (1991) 'Identity through detail: an architecture and cultural aspiration in Montagu, South Africa, 1850-1915', *TDSR*, vol. II, pp. 17-33.
- Dharmayuda, IMS (1995) *Kebudayaan Bali: pra Hindu, masa Hindu dan pasca Hindu*. Denpasar: CV Kayumas Agung.
- Dwijendra, NKA (2008) *Arsitektur Rumah Tradisional Bali, Berdasarkan Asta Kosal Kosali*, Denpasar: Udayana University Press.
- Dwijendra, NKA (2009) *Arsitektur Kebudayaan Bali Kuno*, Denpasar: Udayana University Press.
- Eiseman Jr, FB (1989) *Sekala and niskala: essays on religious, ritual and art*, vol. I, Periplus Editions, Singapore.
- Fersch, P & Gramelhofer, A (2004) 'Architecture as information space,' *Proceedings of the Eighth International Conference on Information Visualisation (IV'04)*.
- Hobart, A, Ramseyer, U & Leemann, A (2001) *The people of Bali*. Massachusetts: Blackwell Publishers Ltd.
- Hall, S (1990) 'Cultural identity and diaspora,' in J Rutherford (ed), *Identity, community, culture difference*, Lawrence and Wishart, London, pp. 222-237.
- Hobart, M (1978) 'The path of soul: the legitimacy of nature in Balinese conceptions of space,' in G Milner (ed.), *Natural symbols in South-East Asia*, School of Oriental and African Studies, London, pp. 5—28.
- Hoben, A & Hefner, R (1991) 'The integrative revolution revisited,' *World Development*, vol. 19, no. 1, pp. 17-30.
- Hobsbawm, E. (1983) 'Introduction: inventing traditions', in E Hobsbawm & F Ranger, (eds), *The invention of tradition*, Cambridge University Press, Cambridge, pp. 1
- Kagami, H (1988) *Balinese traditional architecture in process*, Inuyama: the Little World Museum of Man.
- Lozanovska, M (2011) 'Holy days after migration,' *2nd International Conference on Intangible Culture*, Green Lines Instituto, Barcelos, pp. 459-469.
- Mantra, IB (1993) *Bali masalah sosial budaya dan modernisasi*. Denpasar: Upada Sastra.
- Nordholt, HS (1986) *Bali: colonial conceptions and political change 1700-1940 from shifting hierarchies to 'fixed' order*, Rotterdam: Erasmus.
- Picard, M (1996) *Bali: cultural tourism and touristic culture*. Singapore: Archipelago Press.
- Poerwadarminta, WJS (1989) *Kamus Besar Bahasa Indonesia*. Jakarta: Balai Pustaka.
- Proshansky, HM et al. (1983) 'Place identity: physical world socialization of the self,' *Journal of Environmental Psychology*, vol. 3, pp. 57-83.
- Putra, IDGADP (2015) 'The impact of tourism on the transformation of the tradisional Balinese house, unpublished Ph.D. thesis, Melbourne: Deakin University Australia.
- Shils, E (1971) 'Tradition,' *Comparative Studies in Society and History*, vol. 13, no. 2, Special Issue on Tradition and Modernity, pp. 122-159.
- Swellengrebel, JL (1984) Introduction, in JL Swellengrebel (ed), *Bali: studies in life, thought, and ritual*, Foris Publication Holland, Netherlands, pp. 1-76.
- Wikstrom, T (1995) 'The home and housing modernization,' in DN Benjamin, *The home: words, interpretations, meaning, and environment*. Avebury: Aldershot.
- Wood RE (1993) 'Tourism, culture and the sociology of development,' in K Hitchcock & Parnwell (eds), *Tourism in South-East Asia*, Routledge, London, pp. 48-70.